

## Single Pipe Roller Support

**Material:** Steel Axle with Cast Iron Roller

**Finish:** Plain or Hot Dipped Galvanized

**Designed for Suspending Pipe Where Longitudinal Movement and Vertical Adjustment is required.**

**Comply with Federal Specification WW-H-171E and**

**American Manufactures Standardization Society MSS SP-69 & SP-58(Type 41)**

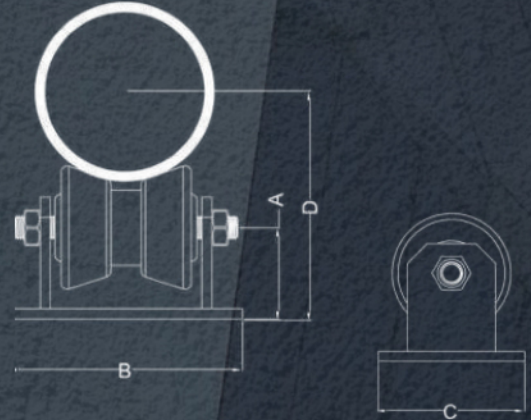
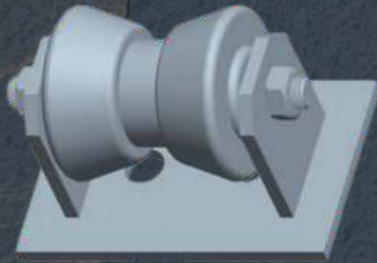

Nominal Pipe Size		A		B		C		D		Max.Rec.Load	
IN	MM	IN	MM	IN	MM	IN	MM	IN	MM	LBS	KG
2"	50	1 3/4	44.4	8 3/8	212.7	6	152.4	3 11/16	93.7	390	177
2-1/2"	65	1 3/4	44.4	8 3/8	212.7	6	152.4	3 15/16	100	390	177
3"	80	1 3/4	44.4	8 3/8	212.7	6	152.4	4 1/4	107.9	390	177
3-1/2"	90	1 3/4	44.4	8 3/8	212.7	6	152.4	4 1/2	114.3	390	177
4"	100	2 1/16	52.4	9 7/8	250.8	6	152.4	5	127	950	431
5"	125	2 1/16	52.4	9 7/8	250.8	6	152.4	5 9/16	141.3	950	431
6"	150	2 1/16	52.4	9 7/8	250.8	6	152.4	6 1/16	154	950	431
8"	200	3 7/16	87.3	8 5/8	219.1	8	203.2	8 13/16	223.8	2100	953
10"	250	3 7/16	87.3	8 5/8	219.1	8	203.2	9 7/8	250.8	2100	953
12"	300	3 7/8	98.4	10 15/16	277.8	8	203.2	11 7/16	290.5	3075	1395
14"	350	3 7/8	98.4	10 15/16	277.8	8	203.2	12 1/16	306.4	3075	1395
16"	400	4 1/4	107.9	12 3/8	314.3	10	254.0	13 5/8	346.1	4980	2259
18"	450	4 1/4	107.9	12 3/8	314.3	10	254.0	14 11/16	373.1	4980	2259
20"	500	4 3/8	107.9	12 3/8	314.3	10	254.0	15 11/16	398.5	4980	2259
24"	600	5 1/8	111.1	13 1/2	431.8	10	254.0	17 11/16	449.3	6100	2767
30"	750	5 3/4	130.2	17	508	10 3/4	273	21 3/4	552.4	7500	3402

Measurements are subject to 5% tolerance.

Due to continuous improvement, product specifications are subject to change without prior notice.